

Arachnid

By Patti Carey of Patti's Patchwork
for *Quilt Block Mania* May 2022



Finished Size: 12" square

Skill level: Confident beginner

Fabrics used: Northcott's *Toscana* suede-look texture

Fabric	Cutting Instructions
A –background - (#9020-640 grasshopper cocktail)	◇ Cut (1) 12½" square
B – contrast (#9020-492 moody blues)	◇ Cut (1) 5½" circle, (2) 18" x 1" strips and (2) 12½" x 1" strips

Piecing: All seams are ¼" unless noted.

Tip for aligning patches for sewing: When you have 2 patches to be sewn together and they are sloped at opposite angles, they are correctly aligned when they meet at the ¼" seam line as shown at right. When you have 2 patches to be sewn together and only one is sloped at an angle, they are correctly aligned when they meet ⅜" from the edge as shown at far right. However, sew them together with a ¼" seam.



1. Select the Fabric A square. Measure 1¾" in from left corner along top edge, and 1¾" in from right corner along bottom edge. Draw a diagonal line connecting the marks and cut along line.

2. Center left section on an 18" Fabric B strip; sew, finger-pressing seam toward B. Trim ends of B in line with top and bottom edges of A.

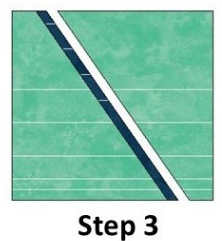
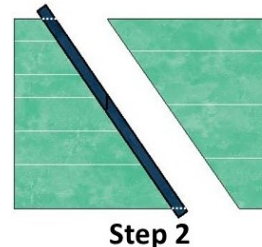
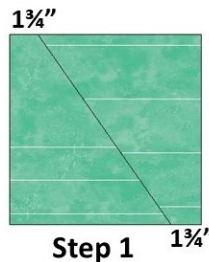

3. Sew right section to other long edge of B, aligning ends at the seam line (use tip above); press toward B.

4. Measure 1¾" down from top corner along left edge of block, and 1¾" up from bottom corner along right edge. Draw a diagonal line connecting the marks and cut along line. Following steps 2 and 3 above, insert the remaining 18" Fabric B strip.

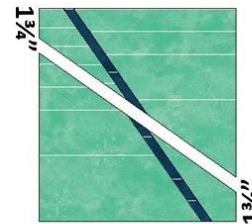

Step 4

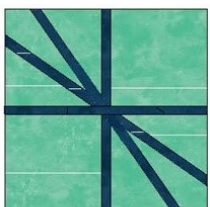

Step 6

5. Cut block in half vertically and insert a 12½" Fabric B strip at cut, pressing seams toward B.

6. Similarly, cut block in half horizontally and insert the remaining 12½" Fabric B strip at cut, pressing seams toward B.

7. Press edge of Fabric B circle under $\frac{1}{4}$ ". Center on block and invisibly machine- or hand-stitch in place using matching thread. To reduce bulk, trim away the portion of the block that is behind the circle, leaving a $\frac{1}{4}$ " seam allowance.



If you like this pattern you'll love all the great patterns at www.pattispatchwork.com – home of the awesome [E-Z Miter/Lone Star Tool](#) and quilt patterns using time-saving efficient methods.

[Sign up](#) for the monthly newsletter for quilty goodness and subscriber-only specials. Also

subscribe to Patti's 2-3x/month blog at www.pattispatchwork-blog.com for quilting tips and tasty recipes. It's not too late to **join me** for the *For the Brave/With Glowing Hearts Quilt-along* March – December 2022 for 10 tip-filled months of learning , fun and prizes. Get all the details and sign up [here](#).

